

S3b Sim Secual / S3b Sim Vid Secual

GSM Alarm System

Features

- GSM frequency: 850 / 900 / 1800 / 1900 MHz
- Supports up to 10 remote controls, 50 wireless accessories and 50 RFID tags
- Can store up to 5 phone numbers, 5 SMS numbers
- Radio-frequency security of the accessories: more than one million code combinations
- Arm / disarm the system by SMS, phone call, or App (on iOS or Android)
- Can be disarmed by RFID tag
- Built-in siren (100dB) and call function from the panel
- SMS alerts for power failure, power recovery and low battery
- Audio surveillance of the site from distance
- 2 x 800 mAh lithium batteries included (8h battery life in standby mode)

Specifications

Product name

S3b Sim Secual

SKU

S3b-S

Control panel power supply

Input: AC 110-240V / 50-60 Hz

Output: DC 12V / 800 mA

GSM operating frequency

850 / 900 / 1800 / 1900 MHz

Radio-frequency

433 MHz (± 75 KHz)

Standby current

110 mA

Alarm current

340 mA

Backup batteries

Lithium batteries: 3.7 V / 800 mAh x 2 (BL-5B)

Internal siren

100 dB

Housing material

ABS plastic

Operating conditions

Temperature: -10°C ~ 55°C

Humidity: $\leq 80\%$ (non-condensing)

Control panel dimensions (L x W x H)

188 x 132 x 26 mm

Box Content

S3b Control Panel x1

Motion Detectors x2

Door / Window Contacts x2

Remote Controls x2

RFID Tags x2

AC Adaptor x1

Documentation x1

S3b Sim Vid Secual

+ IP Camera x 1 (with AC Adaptor and manual)

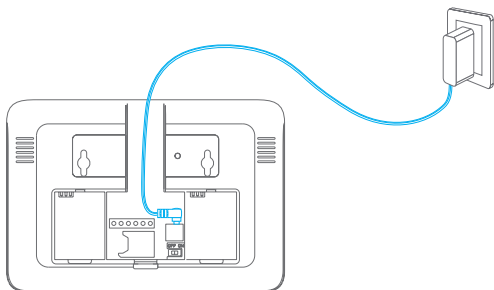

Quick Start-up

Control Panel Layout (Front)

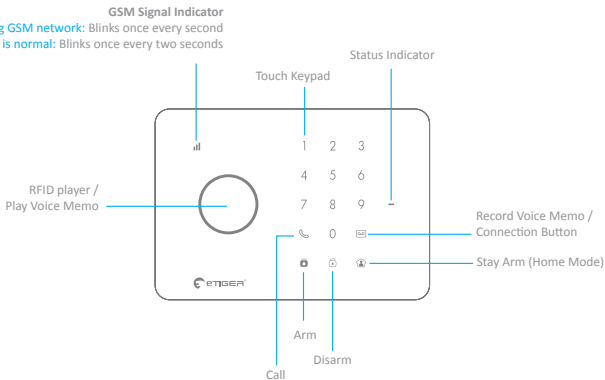

Control Panel Layout (Back)

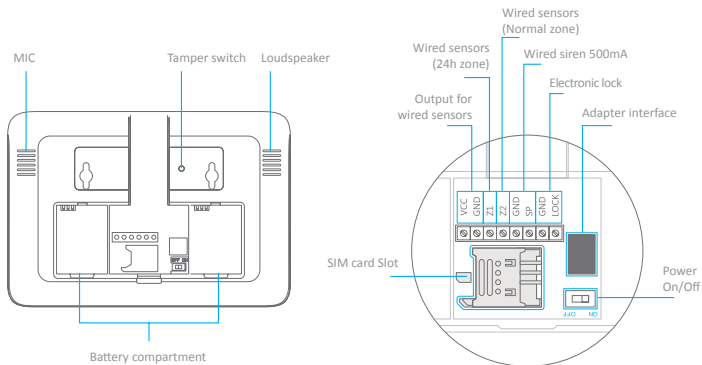

Connect your System

Open the battery case at the back of the control panel and insert a SIM card in the control panel.

Important

Before using the S3b Sim Secual, you need to purchase a SIM card that works on the GSM network with 850 / 900 / 1800 / 1900 MHz frequency. We recommend you to subscribe to a plan with unlimited texts and one hour of voice. For more information, please contact your local reseller.

Important

Make sure the SIM card does not require any PIN code. For more information, please contact your local reseller.

Turn your System On

1. Plug the AC adaptor to an AC socket.
2. Plug the output connector of the AC adaptor into the adaptor interface in the battery compartment at the back of the control panel.
3. Turn the power switch to "ON" (in the battery compartment at the back of the control panel).

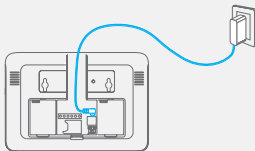

Mount the Control Panel

Before mounting the control panel on the wall, make sure the reception of the GSM signal is sufficient.

Fix the wall-mounting bracket on the wall with screws. Wedge the panel on the bracket, make sure they fit well.

First Operations

Store a phone number

To interact with the control panel by SMS, by phone call and/or from the app, at least one phone number for SMS notifications must be stored in the control panel. Please refer to the instructions page 13 of this manual.

Change the language

By default the language of the S3b control panel is set to English. If you wish to change the system language, refer to the instructions page 18 of this manual. "System language" refers to the language of the SMS you receive from the control panel.

Arm / Disarm the System

The alarm system can be armed or disarmed on the control panel, by SMS, by App and by phone call.

On the control panel: Refer to the instructions on page 9 of this manual.

By SMS

To arm the system: Send "1" by SMS to the number of your system's SIM card.

To disarm the system: Send "0" by SMS to the number of your system's SIM card.

By RFID tag (disarm only): Swipe the RFID tag in front of the RFID reader of the control panel. *To start receiving SMS notifications when the system is disarmed by RFID tag, you must store an SMS number as explained on page 13 of this manual. If you have stored several SMS numbers, only the first number stored will receive SMS notifications when the system is disarmed by RFID tag.*

By app

In the app, click on "Arm" or "Disarm" to respectively arm or disarm the system.

The app is available for download on the App Store and Google Play (more information on etiger.com).

Register Wireless Accessories & RFID Tags

1. Type your password followed by the Connection button "🔗" on the control panel to enter the Connection Mode.
2. Trigger the accessory once within the next 15 seconds (for the RFID tag, swipe it in front of the blue circle of the control panel). You hear one beep: the registration is successful.

Default password is 1234. To change the password, refer to instructions on page 18.

If the accessory has already been registered, the control panel will beep twice. The first accessory registered is assigned to zone 1, the second accessory registered is assigned to zone 2, etc. Zones 1 to 9 can be renamed. Zones 10 to 50 cannot be renamed (refer to the instructions on page 15 to learn how to rename zones).

Speed Dial

This function is only available when the system is disarmed.

Press the Call button “☎” on the control panel for 3 seconds: the panel auto-dials the first stored phone number. Press the Call button “☎” to end the call.

Hands-Free Phone Call from the Panel

This function is only available when the system is disarmed.

Type the phone number you wish to call and press the Call button “☎”.

Record / Play a Voice Memo

Long press the Record Voice Memo button (🗣️) to record a 10-second voice message. The Play Voice Memo Button blinks when a message has been recorded.

Touch the center of the circle on the control panel to listen to the voice memo. The LED indicator turns off when the voice memo is being played. Touch it again to replay the memo.

Hard Reset

Turn the control panel on (if the control panel is already on, turn it off and turn it on again). Press the tamper switch at the back of the control panel 5 times within 5 seconds after having turned it on.

Settings will be restored to default values. Stored phone numbers and connected accessories will be cleared.

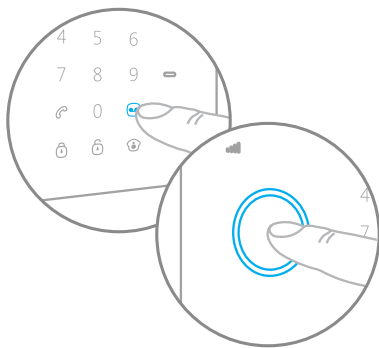

Control Panel Operations

Arm the System

Press the Arm button "" on the control panel. The control panel beeps once: the system is armed.

Note

If the Entry / Exit Delay is activated, only the Delay zone will be armed after the delay set (refer to instructions on page 17 of this manual "Entry / Exit Delay").

Disarm the System

Type your password and press the Disarm button "" on the control panel. The control panel beeps twice: the system is disarmed.

Home Mode

Press the Stay button "" on the control panel. The control panel beeps twice: the system is armed in Home Mode.

In Home Mode, all the sensors are armed except those assigned to the Home zone. Sensors assigned to the Home Mode zone are disarmed: they cannot trigger an alarm.

For more information on zone setup, please refer to the instructions on page 29 of this manual.

Control by Phone Call

Method 1

When an alarm has been triggered, the control panel dials the pre-stored phone numbers. When you take the call, you can control the panel from distance according to the instructions in the table below.

Method 2

1. Dial the telephone number of the SIM card in your control panel.
2. Enter your password followed by "#".*
3. Select the operations to control the panel (see instructions in the table below).

Note

The call will end automatically if you do not send any command within 30 seconds.

*Default password is 1234.

Table of commands for control by phone call

Command	Function	Comment
Press "1"	Arms the system	-
Press "0"	<ul style="list-style-type: none"> - Disarms the system and turns the siren off - Stops monitoring without hanging up - Ends the phone call without hanging up 	-
Press "*"	Audio monitoring	-
Press "3"	Phone call with control panel	-
Press "6"	Turns the siren off	-
Press "9"	Turns the siren on	-
Press "#"	<ul style="list-style-type: none"> - Disarms the system and turns the siren off - Exits control by phone call 	Hanging up also exits the control by phone call.

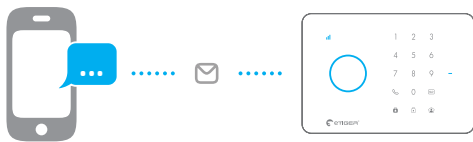

SMS Operations

IMPORTANT: BEFORE USING FOR THE FIRST TIME

INSERT A SIM CARD IN THE CONTROL PANEL.
MAKE SURE THE SIM CARD DOES NOT REQUIRE ANY PIN CODE.

SAVE A PHONE NUMBER FOR SMS NOTIFICATIONS. (Refer to instructions on the opposite page)
Only stored numbers can control and configure the system.

Each SMS operation defined in this user manual will be illustrated as follows.

You send:



The first blue speech bubble is the SMS command sent by the user.

The control panel replies:

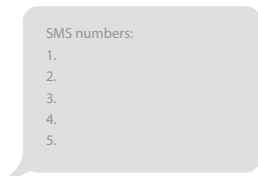

The first grey speech bubble is the reply sent by the control panel.

The speech bubbles that follow are the dialogue between the user and the control panel (SMS sent by the user are in blue, SMS sent by the control panel are in grey).

The system is in English by default. To change the system language, refer to page 19 of this manual.

Important

When replying to the control panel by SMS, make sure no space follows punctuation marks like "!" or ":". For examples, to store SMS numbers, your SMS must be formatted as follows:

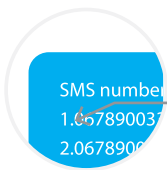
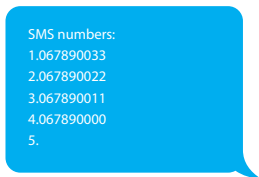

No space after "1."

Store Phone Numbers for SMS notifications

Send:

6

SMS numbers:

- 1.
- 2.
- 3.
- 4.
- 5.

Copy, paste, then edit
(case sensitive):

SMS numbers:

- 1.067890033
- 2.067890022
- 3.067890011
- 4.067890000
- 5.

Ok

Note

The first SMS number will receive SMS notifications when the system is disarmed by RFID tag.

Disarm the System

Send:

0

System disarmed.

Arm the System

Send:

1

System armed.

Home Mode

Send:

2

System in home mode.

Settings Enquiry

Send:

00

System:Disarmed
AC power:on

Note

The values indicated hereinabove will change after having set up the system.

Store Phone Numbers

Send:

5

Phone numbers:

- 1.
- 2.
- 3.
- 4.
- 5.

Copy, paste, then edit
(case sensitive):

Phone numbers:

- 1.067890033
- 2.067890022
- 3.067890011
- 4.067890000
- 5.

Ok

Rename Zones

Send "91~99". For example for zone 1, send:

91

Zones names:

- 1.

Copy, paste, then edit
(case sensitive):

Zones names:

- 1.Entrance door sensor

Ok

Note

Zones 1 to 9 can be renamed. The name of the zone cannot consist of more than 30 Latin characters. Zones 10 to 50 cannot be renamed.

SMS Alert for Accessory Low Battery

(available for two-way accessories such as Motion Detectors)

For accessories assigned to zones that have been renamed, an SMS will be sent under the format "**Zone number + zone name + Low BAT**".

Zone 10 Bedroom PIR Low BAT

For accessories assigned to zones that have not been renamed, an SMS will be sent under the format "**Zone number + Low BAT**".

Zone 10 Low BAT

SMS Alert for Accessory Tamper Alarm

(available for two-way accessories such as Motion Detectors)

For accessories assigned to zones that have been renamed, an SMS will be sent under the format "**Zone number + zone name + Tamper**".

Zone 10 Bedroom PIR Tamper

For accessories assigned to zones that have not been renamed, an SMS will be sent under the format "**Zone number + Tamper**".

Zone 10 Tamper

Rename RFID Tag

Send:

10

Rename RFID tags:

- 1.
- 2.
- 3.
- 4.

Copy, paste, then edit
(case sensitive):

Rename RFID tags:

- 1.Tom
- 2.Nurse
- 3.Nancy
- 4.David

Ok

Note

The first SMS number will receive SMS notifications when the system is disarmed by RFID tag.

If the RFID tag that disarms the system has been renamed, the SMS notification will be "**Tag 01 Tag name Disarm**". ("01" is the number of the tag)

Other tags will be attributed a number based on the order of registration to the control panel; the SMS notifications will in such case be "**Tag-04 Disarm**" ("04" is the number of the tag). Refer to the instructions on page 28 to learn how to register an RFID tag in the control panel.

Entry and Exit Delay Time

Send:

11

Entry delay time(0-300sec):0
Exit delay time(0-300sec):0

Copy, paste, then edit
(case sensitive):

Entry delay time(0-300sec):10
Exit delay time(0-300sec):20

Ok

Note

This function will only affect detectors assigned to the Delay zone. Refer to the instructions on page 29 of this manual to learn how to set up your sensor to the Delay zone.

This function can be used if you do not want to bring a remote control or a RFID tag with you.

When you arm the system, the system will be armed after the delay set. When you disarm the system, the system will be disarmed after the delay set.

When arming the system, you hear one beep every second to remind you to leave. The beep rhythm speeds up during the last 10 seconds. If an intruder is detected, the alarm will be delayed accordingly.

Siren Volume and Ringing Time

Send:

12

Siren volume(0=Mute,1=High):1
Siren ringing time(1-9min):3

Copy, paste, then edit
(case sensitive):

Siren volume(0=Mute,1=High):0
Siren ringing time(1-9min):1

Ok

Change the Password

Send:

13

Disarm password (4 digits):
1234

Copy, paste, then edit
(case sensitive):

Disarm password (4 digits):
8888

Ok

Change System Language

Send the code corresponding to the language you want to set. For example, for English, send "0001".

0001

Ok

Refer to the table below for the full list of language codes:

0001 English	0008 German
0002 French	0009 Spanish
0003 Russian	0010 Finnish
0004 Danish	0011 Norwegian
0005 Dutch	0012 Arabic
0006 Italian	0013 Farsi
0007 Swedish	

Languages available may vary depending on the version of your product.

Restore System to Factory Settings by SMS

Send:



0000



Ok

The settings will be restored to default values. Stored phone numbers and connected accessories will also be deleted.

Note

Only stored numbers can send the SMS to restore factory settings.

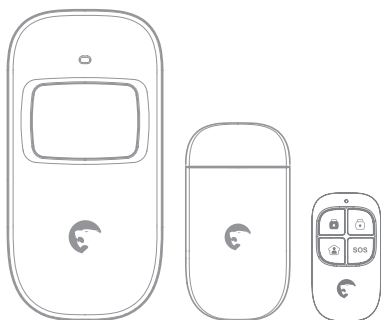

Accessories



Arm the system

Press the Arm button  to arm the alarm system. The LED indicator lights up (the control panel beeps once). The system is armed.

If an intruder is detected, the siren rings out. (The siren turns off after 3 minutes as per default settings.) In the meantime, the system dials the pre-stored phone numbers automatically.



Disarm the system

Press the Disarm button  to disarm the alarm system. The LED indicator turns off (the control panel beeps twice). The system is disarmed.

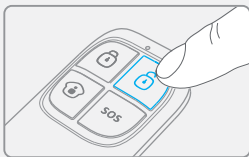

Home Mode

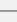
Press the Home Mode button  on the remote control. The system state LED is on. All the sensors in regular zones are armed except those in the Home Mode zone. The sensors in the Home Mode zone are disarmed so that users can move inside their home.



Mute Mode

Press the Home Mode button "🏠" and the Arm "🔒" or Disarm "🔓" button immediately after. Doing so, the control panel does not ring out when you arm or disarm your system.

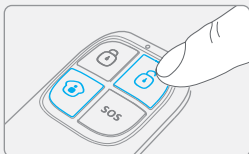

Emergency Mode

Regardless the status of the system, the alarm is triggered when the SOS button "SOS" is pressed on the remote control.

At the same time, the control panel sends a notification by SMS ("RC-01 SOS", 01 being the remote control's number) and dials the pre-stored phone numbers.

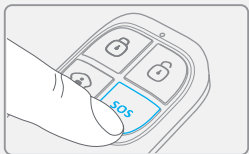

Register in the control panel

Type your password followed by the Connection button "📶" on the control panel to enter the Connection Mode. Press any button on the remote control.

Specifications

Power supply:

DC 3V (CR2025 button battery x1)

Static current:

10 uA

Operating current:

≤7 mA

Transmission distance

≤ 80 m (in open area)

Radio-frequency:

433MHz (±75KHz)

Housing material:

ABS plastic

Operating conditions:

Temperature: -10°C ~ +55°C

Relative Humidity: ≤80%
(non-condensing)

Dimensions:

57 x 31 x 11 mm

Wireless Motion Detector

Features

The ES-D1A is a high performance wireless motion detector boasting a digital dual-core fuzzy logic infrared control chip with intelligent analysis. This technology identifies interferences created by body motion and reduces the false alarm rate.

With automatic temperature compensation and anti-air turbulence technology, it easily adapts to environmental changes.

Design

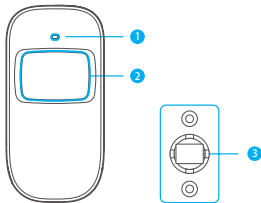

1. LED indicator
2. Detection window
3. Bracket

PCB Layout

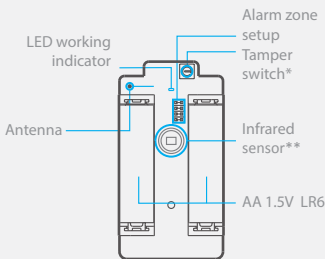

*Tamper switch

When the alarm system is armed, the tamper switch will trigger the alarm if the case is opened.

**Infrared sensor

Detects the infrared rays released by human body motion. Do not touch the surface. Keep the surface clean.

LED indications

Blinks continuously: self-testing

Blinks once: an intruder is detected

Blinks twice: self-testing is complete; entering working mode.

Blinks once every 3 seconds: under-voltage indication: the batteries must be replaced. (You will be informed by SMS when the batteries are low if the motion detector is registered in the control panel.)

Usage

Open the case and remove the battery activation strip. Self-testing will start for 30 seconds.

When the sensor is in operation, if it is triggered more than twice within 3 minutes, it switches to standby mode to save power. If no movement is detected within the next 3 minutes, the sensor goes back to working mode.

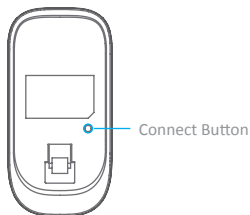

Register in the control panel

Type your password followed by the Connection button "☺" on the control panel to enter the Connection Mode. Press the connect button at the back of the motion sensor or trigger the sensor (by moving in front of it).

Installation

Avoid mounting the detector close to windows, air conditioner, heater, refrigerator, oven, sunshine and places where the temperature changes fast or where the air stream flows frequently.

If two detectors are installed in the same detection scope, adjust the location to avoid interferences and false alarms.

Fix the bracket on the wall with screws and attach the detector to the bracket. Adjust the bracket to change the detection distance and angle. It is recommended to mount the detector 2,2 m from the ground.

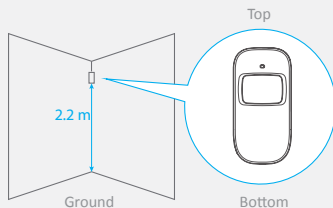

The detector is more sensitive to cross movements than vertical movements.

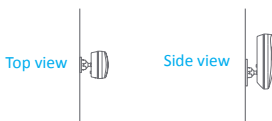

Test

A. After the installation, turn the detector on. After one minute of self-testing, press the test button, walk in the scope of detection and watch the LED indicator to make sure the detector is working.

B. The LED indicator blinks once when body movement is detected.

C. Adjust the detector angle to achieve the best detection performance.

Specifications

Power supply

DC 3V (AA 1.5V LR6 Batteries x 2)

Static current

≤ 30 μ A

Alarm current

≤ 15 mA

Detection scope

8m / 110°

Transmission distance

≤ 80m (in open area)

Radio-frequency

433 MHz (\pm 75 KHz)

Housing material

ABS plastic

Operating conditions

Temperature: -10°C~55°C

Relative humidity: ≤ 80% (non-condensing)

Detector dimensions (L x W x H)

107 x 53 x 32 mm

Bracket dimensions (L x W x H)

52 x 30 x 26.5 mm

Detection Scope

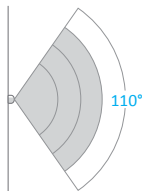

Top view

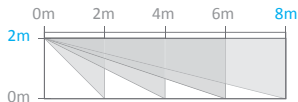

Side view

Wireless Door / Window Contact

Features

The ES-D3A/B/C is a Door / Window Contact that can be installed on doors, windows, and any other objects that open and close. The sensor sends a signal to the control panel when the magnet is separated from the transmitter.

Thanks to the tamper switch, any attempt to remove the cover of the Door / Window Contact will trigger the alarm.

Design

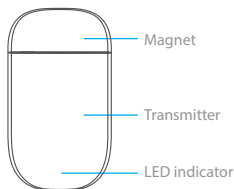

PCB Layout (ES-D3A/ES-D3B)

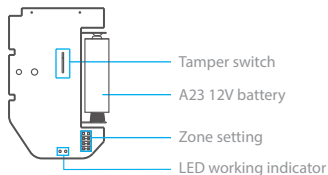

LED indications

Blinks once: the door or window is open and the transmitter sends a signal to the control panel.

Blinks quickly: Low power indication, the batteries must be replaced.

PCB Layout (ES-D3C)

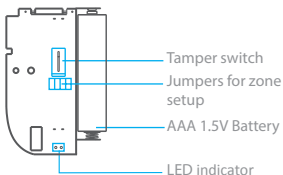

Register the detector in the alarm system

Type your password followed by the Connection button "☺" on the control panel to enter the Connection Mode. Then separate the magnet from the transmitter.

To check if the registration is complete, arm the system and separate the magnet from the transmitter again by opening the door or window on which it is installed. If the siren rings out, the registration is successful.

Installation

- Open the case and remove the battery activation strip.
- Mount the sensor on the door and the magnet on the door frame.
- Make sure the magnet is placed above the transmitter.
- Mount the magnet max. 1 cm away from the transmitter and secure the transmitter and magnet with double-sided tape or screws.
- Avoid mounting the sensor in areas with a large amount of metal or electrical wiring such as a furnace or utility room.

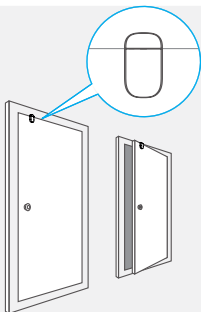

Specifications (ES-D3A/ES-D3B)

Power supply

DC 12V (A23 12V Battery x 1)

Static current

≤ 30 uA

Alarm current

≤ 15 mA

Transmitting distance

≤80 m (in open area)

Radio-frequency

433 MHz (±75 KHz)

Housing material

ABS plastic

Operating conditions

Temperature: -10°C~55°C

Relative humidity: ≤ 80% (non-condensing)

Transmitter dimensions (LxWxH)

60 x 45 x 18 mm

Magnet dimensions (LxWxH)

45 x 19 x 17.5 mm

Specifications (ES-D3C)

Power supply

AAA 1.5 V Battery x1

Static current

≤ 30 uA

Alarm current

≤ 15 mA

Transmitting distance

≤80 m (in open area)

Radio-frequency

433 MHz (±75 KHz)

Housing material

ABS plastic

Operating conditions

Temperature: -10°C~55°C

Relative humidity: ≤ 80% (non-condensing)

Transmitter dimensions (LxWxH)

60 x 45 x 18 mm

Magnet dimensions (LxWxH)

45 x 19 x 17.5 mm

RFID Tag

Features

The RFID tag enables you to disarm your system or unlock electronic door locks (connected to an eTiger keypad).

Register the RFID tag in the alarm system

Type your password followed by the Connection button "☺" on the control panel to enter the Connection Mode. Swipe the RFID tag in front of the RFID reader on the control panel.

Specifications

Dimensions

45 x 30 x 7 mm

Register an Additional eTiger Siren

The control panel of the S3b features a built-in 100 dB siren. Your eTiger security systems supports additional indoor and/or outdoor sirens so to enable you to extend your system according to your needs.

To register an additional eTiger siren, refer to the instructions provided in the manual that comes with your siren.

For more information on sirens and accessories compatible with eTiger security systems, visit our website etiger.com

Zone Setup of Accessories

Every detector can be assigned to 4 different categories of zones: Home Mode Zone, Single Delay Zone, Normal Zone and 24hZone. To assign a detector to a zone, open its case and move its jumpers according to the drawing below:

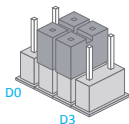

A. Home Mode zone

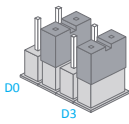

B. Delay zone

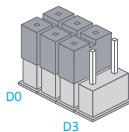

C. Normal zone

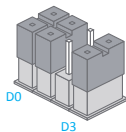

D. 24h zone

Home Mode zone

When the system is armed in Home Mode, the sensors assigned to the Home zone do not trigger an alarm. *It is recommend to assign motion detectors to the Home zone so that you can have your system armed in Home Mode when you are home and move inside your home without triggering any alarm.*

Delay zone

An entry and an exit delay can be set. In such case, sensors assigned to the "Delay Zone" will not trigger an alarm during the time of delay set. For example, if you assign a motion detector to the Delay zone and you set the Entry/Exit Delay to 30 seconds, the motion detector will not trigger an alarm within 30 seconds after you enter your home and within 30 seconds before you leave it so that you can leave and enter your home without triggering an alarm. Refer to the instructions on page 17 of this manual to learn how to set the entry and exit delay. *It is recommended to assign the Door / Window Contact to the Delay zone.*

Normal zone

When the system is armed, if a sensor is triggered, the siren rings out. When the system is disarmed, sensors do not trigger an alarm.

24h zone

Regardless the system is armed or disarmed, sensors assigned to the 24h zone will trigger an alarm. *It is recommended to set smoke detectors, gas detectors and outdoor beam sensors in the 24h zone.*



Safety and Troubleshooting

Issue	Cause of malfunction	Solution
No response following interaction with the control panel	The control panel is switched off	Open the battery compartment and turn the power on
	Electricity grid failure	Contact your electricity provider
	Backup batteries are empty	Plug the AC adapter to an AC socket
Accessories cannot connect to the control panel	The control panel is not in Connection mode	Make sure the control panel is in Connection mode
	Accessories have not been triggered for connection	Make sure the accessory is triggered so to send a signal to the control panel
	When attempting the connection, the control panel beeps twice	The accessory has already been connected Make sure you do not trigger any other accessory when connecting one accessory to the control panel (e.g. do not stay in the detection scope of a motion detector if it is not the one you want to connect)
No response from the control panel following commands from the remote control	The remote control has not been connected to the control panel	Follow the instructions on page 22 of this manual to connect the remote control to the panel
	Remote control is too far from the control panel	Transmission distance of the remote control: 80 m (in open area) A signal repeater can be installed to increase the transmission distance
RFID tag fails to disarm the system	RFID tag has not been connected to the control panel	Follow the instructions on page 6 of this manual to connect the RFID tag to the control panel

If you are experiencing issues that are not described in the FAQ above, visit [etiger.com](https://www.etiger.com) to download the latest update of this user manual and for additional support.

For a safer use of the product and to optimize the lifespan of the product, we recommend you to follow the precautions below:

- The wireless accessories must be connected to the control panel.
- Low power voltage may affect transmission distance.
- Do not press the SOS key on the remote control if it is unnecessary to avoid disturbing neighborhood.
- Check the system regularly to make sure the system works properly.
- The control panel is neither waterproof nor moisture-proof, install it in a shady, cool and dry place.
- The case of the control panel is made of ABS plastic. Keep away from bright light for a longer lifespan.
- The control panel is not explosion-proof. Keep away from fire and flames.
- Install the control panel away from objects such as heater, air conditioner, microwave oven etc. that generate heat or electromagnetic fields.
- Dispose of the batteries according to local regulations.
- Dismantling of this product must be done by professional personnel only.



This product bears the selective sorting symbol for waste electrical and electronic equipment (WEEE). This means that this product must be handled pursuant to European Directive 2002/96/EC in order to be recycled or dismantled to minimize its impact on the environment.

For further information, please contact your local or regional authorities.

Electronic products not included in the selective sorting process are potentially dangerous for the environment and human health due to the presence of hazardous substances.



In compliance with European laws. This product is in compliance with the essential requirements and other relevant provisions of Directive 1999/5/EC.



This product was designed and manufactured in compliance with Directive 2002/95/EC of the European Parliament and of the Council on the restriction of use of certain hazardous substances in electrical and electronic equipment (RoHS Directive - RoHS) and is deemed to comply with the maximum concentration values set by the European Technical Adaptation Committee (TAC).

Manufactured in China.



Images, illustrations and text are non-contractual. ETIGER and the ETIGER logo are registered trademarks and the property of ETIGER. Copyright © 2015 ETIGER. All rights reserved.

